

RECLAMATION CITY OF CANADA BAY

THE
LOT

The Observatory Concepts + Location Plan

STAGE THREE

PUBLIC ARTWORK:



THE OBSERVATORY CABARITA

What:	Playful interactive sculptural instruments will harness, capture and make visible the natural elements, especially wind due to the exposure of the site to strong winds. The works are inspired by the local history of Correy's Pleasure Garden, by 18th century analogue scientific devices for measuring the weather & a Victorian aesthetic.
How:	The Storm Glass Hut houses a storm-glass barometer and weather vane to see the direction of the prevailing wind. The Sundial Windflute creates a listening device to hear the sound of prevailing wind and also the tell the time through the sun dial. The Chaise Lounge Observatory provides a comfortable place to rest and observe the area, incorporating a small wind turbine to show the speed of the prevailing wind.
Why:	The Observatory aims to build awareness, responsiveness and sensitivity to the natural elements in a playful & interactive way.
Mode:	Active, engaged, learning, contributing, interactive
Aesthetic:	Playful, old-school, Victorian, analogue science. There are numerous motifs that are echoed through the three works including the scalloped wing pattern in both the plate and perforated steel and the crystalline formations in the storm glass and galvanised steel.
Materials:	Galvanised steel plate - solid & perforated, laminated glass, marine plywood & sealant.
Placement:	The selected site is exposed to the wind and provides a beautiful vantage point to experience the Parramatta River. (Refer to Cabarita Site Plan). The artworks are located in a group so they create a destination and so they are read as a triptych which relate to one another. The works also allow you to understand the wind in various ways. The Chaise Lounge helps you see the speed of the wind, the Storm Glass Hut tells you the direction of the wind and the Sundial Windflute allows you to hear the sound of the wind.

The Observatory

Montage of artworks in location

THE
LOT



Heidi Axelsen & Hugo Moline © 2012

Looking East at the Observatory.

The Observatory

Montage of artworks in location

THE
LOT

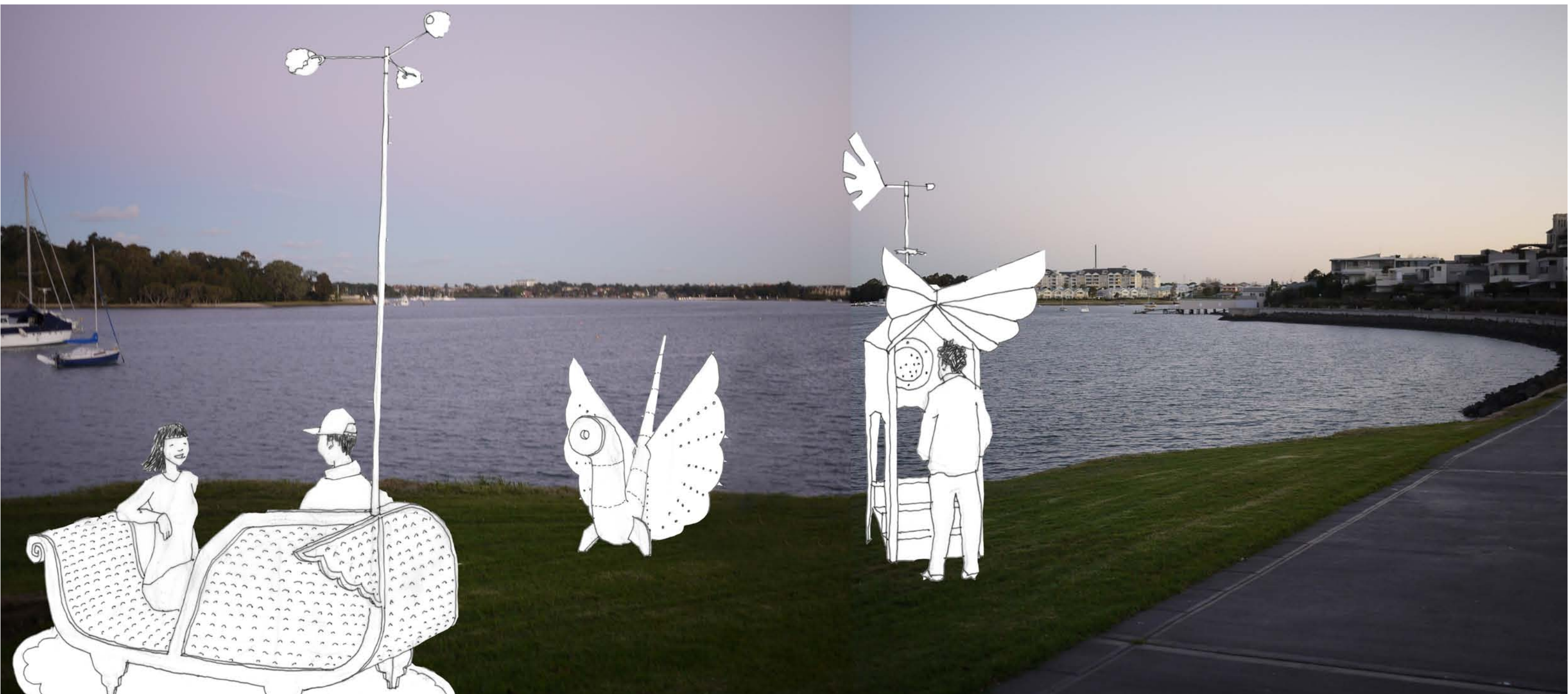

Looking South at the Observatory.

The Observatory

Detail of Storm Glass Hut

Note: Sketch not to scale, artwork in construction

STORM GLASS HUT:

A view finder make visible the natural changes in the atmosphere. The storm glass will sensitise audiences to changing climates and the passing of time.

The storm glass window orientates towards the Parramatta River and the sky capturing the water and the passing clouds in its' view. The also hut provides a small shade structure & a place for contemplating & observing the surrounds.

The work offers two levels of engagement, when the Storm Glass is not active eg. a sunny bright day, you can learn about what patterns to look for through the laser -etched illustrations and you can also discover the direction of the wind, which then encourages you to engage with the other two works which tell you more about the wind.

aesthetic mode:

active, learning, observing, kinetic, responsive to wind & changes in temperature.

materials:

Galvanised 5mm plate steel, double layer 6mm laminated glass, marine grade plywood & sealant, concrete footings.

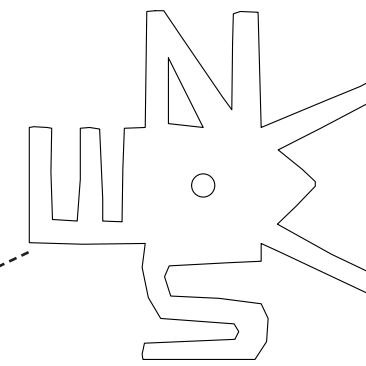
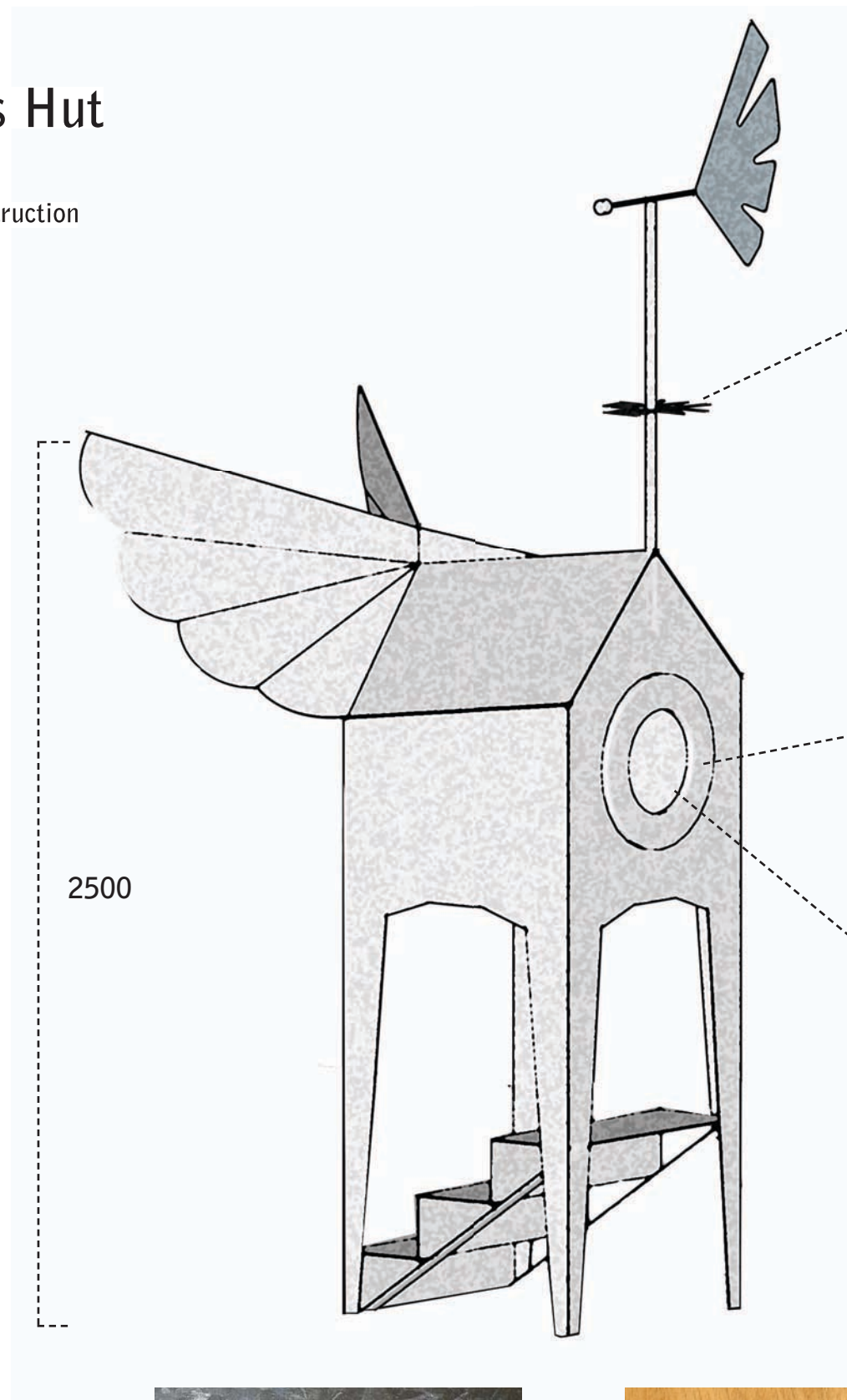

Plan view of compass in 5mm steel plate, which is read from underneath showing the direction of the prevailing wind: North, East, South, West

THE
LOT

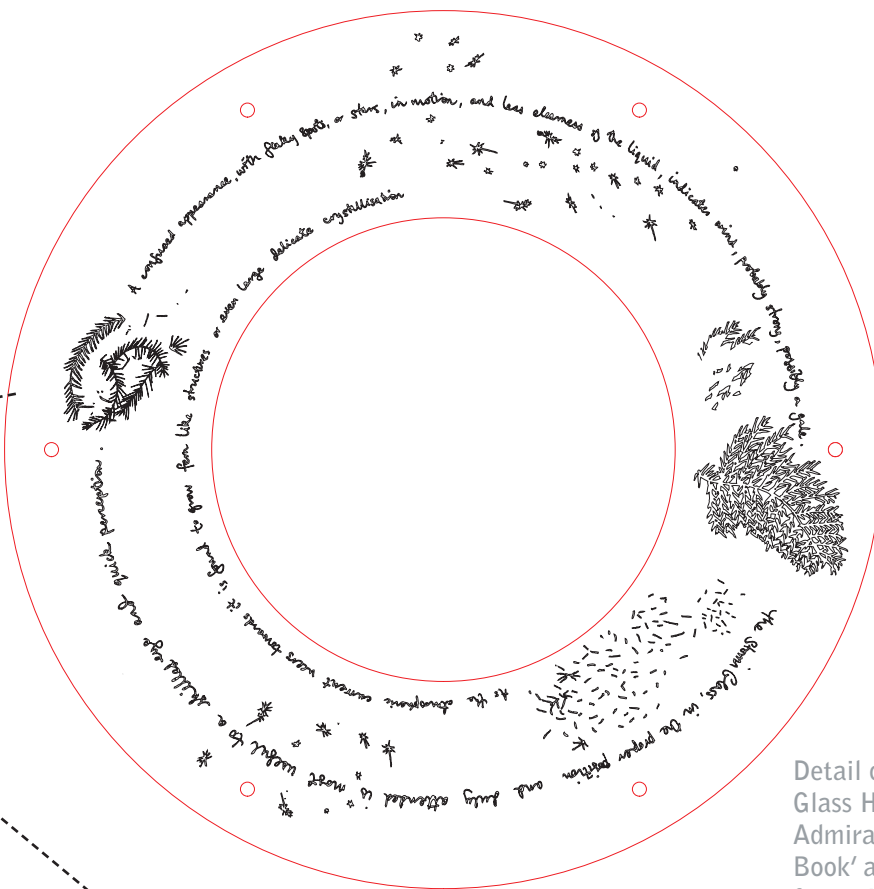

Detail of wooden frame inside Storm Glass Hut, laser-etched phrases from Admiral Robert Fitzroy's 'Weather Book' and illustrations explaining the formations of the Storm Glass



Material sample of galvanised sheet metal. The pattern mirrors that of the crystalline formation in the Storm Glass. The galvanised steel is also resistant to rust & lends easily to graffiti removal.

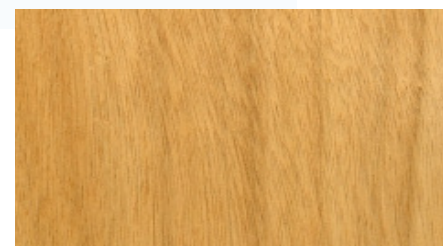

Material sample of marine grade plywood & sealant similar to that used in boating vessels.

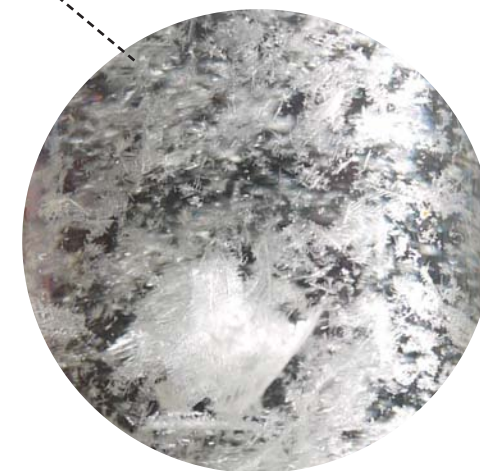

Detail of sample of Storm Glass Liquid concealed in double layer of 6mm laminated glass

Heidi Axelsen & Hugo Moline © 2012

The Observatory

Detail of Sundial Windflute

Note: Sketch not to scale, artwork in concept phase

THE
LOT

SUNDIAL WINDFLUTE:

The Sundial Windflute creates a listening device to hear the sound of prevailing wind and also the tell the time of day by the shadows cast through the sun dial.

The Sundial Windflute engages with the neighbouring Storm Glass Hut by allowing you to hear the sound of the wind, and simultaneously you can read the the direction of the wind through the weather vane on the Storm Glass Hut.

The work offers two levels of engagement, when the wind is soft and not creating much of a sound through the wind flute you can tell the time of by the shadows cast by the sun.

aesthetic mode:

active, learning, participating, kinetic, responsive to wind & sun

materials:

Galvanised metal pipe and sheet, concrete footings.

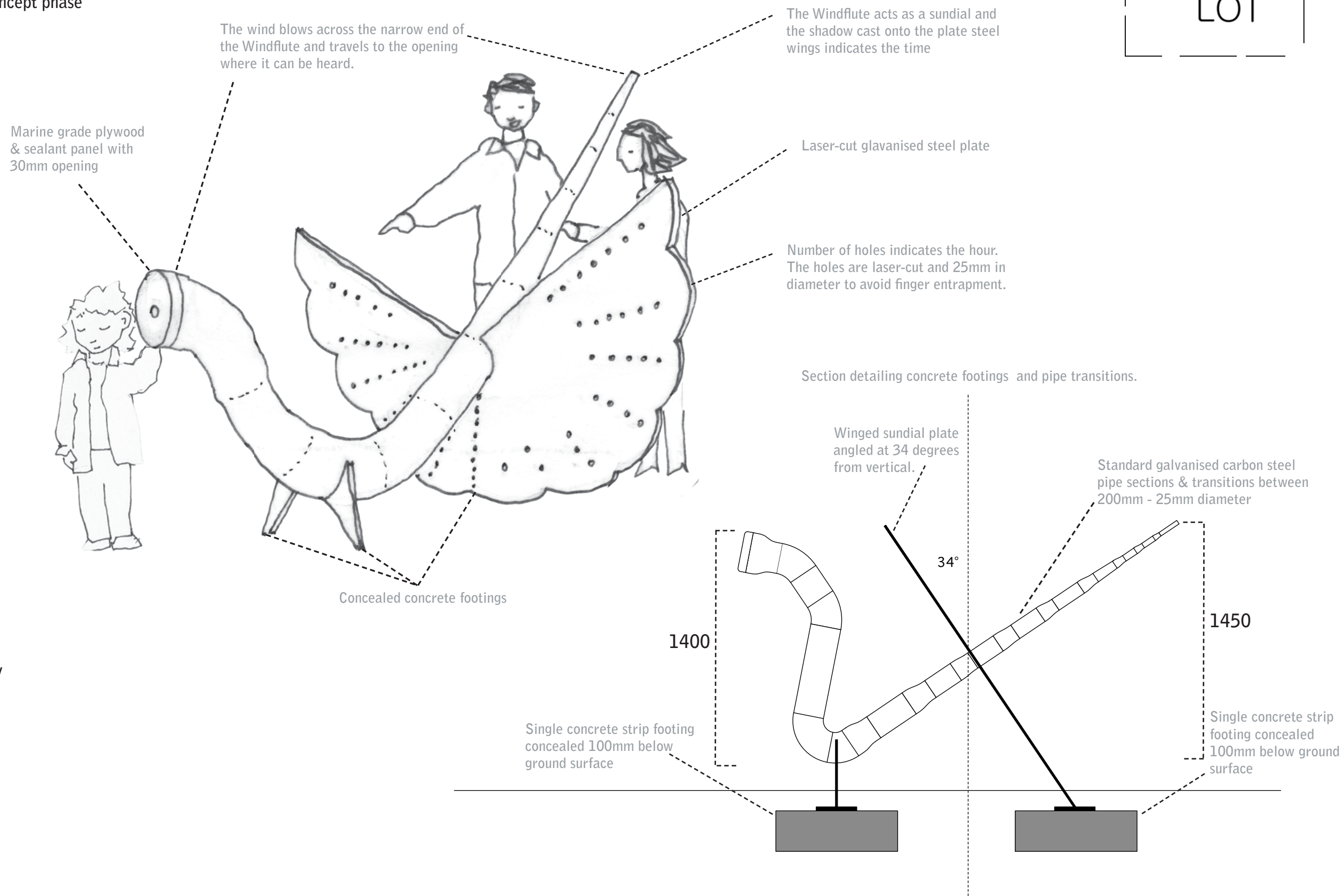

The Observatory

Detail of art seating

Note: Sketch not to scale, artwork in concept phase

THE
LOT

CHAISE LOUNGE OBSERVATORY:

The Chaise Lounge Observatory provides a comfortable place to rest and observe the area and the adjacent artworks. The seat will accommodate up to three adults at one time.

The seat is in the form of a chaise lounge, referencing the period of history where the analogue weather measuring devices arose. The seating also incorporates a small wind turbine in the form of tea cups, referencing the activity of lounging, drinking tea and socialising, the tea cups spin creating a kinetic element to show you the speed of the wind.

The Chaise Lounge sits on a concrete slab in the form of a oval rug imprinted with a scallop patterned rim.

aesthetic mode:

restful, learning, participating, kinetic, responsive to wind

materials:

Galvanised sheet metal perforated with scallop pattern, concrete slab in form of a rug, cast metal cups galvanised & metal pole galvanised.

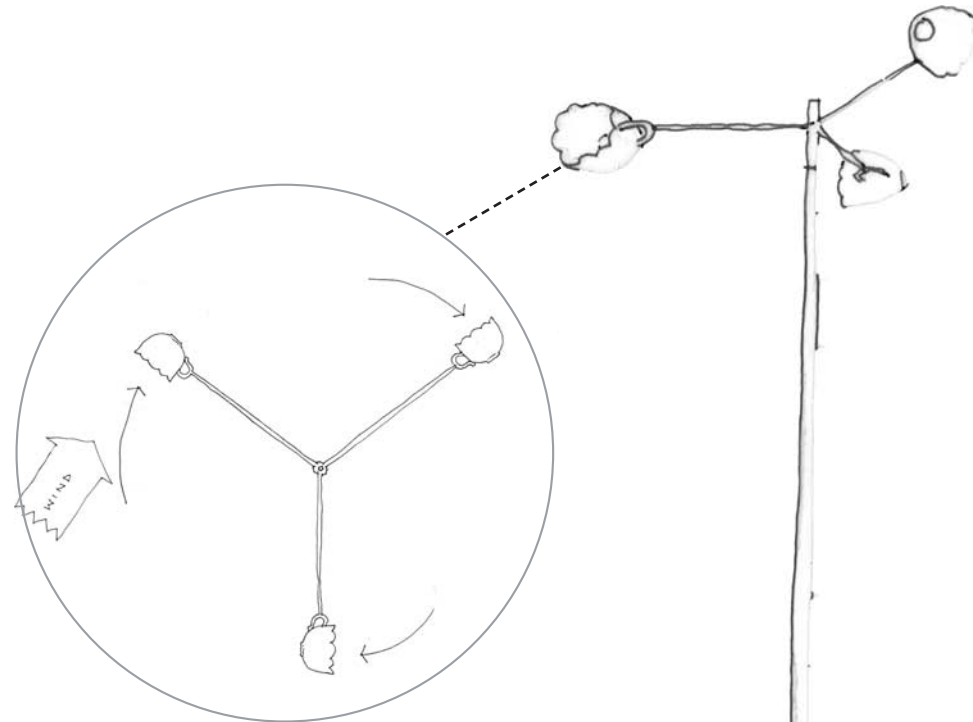

Plan view of tea cup wind turbine, cups are hand modelled and cast in metal & galvanised, the cups are inspired by Victorian pottery & mirrors the scallop pattern from the wings on the Storm Glass Hut and the sundial panel on the Sundial Windflute.

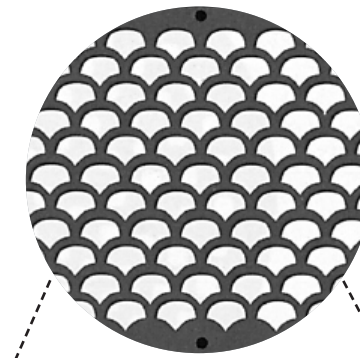
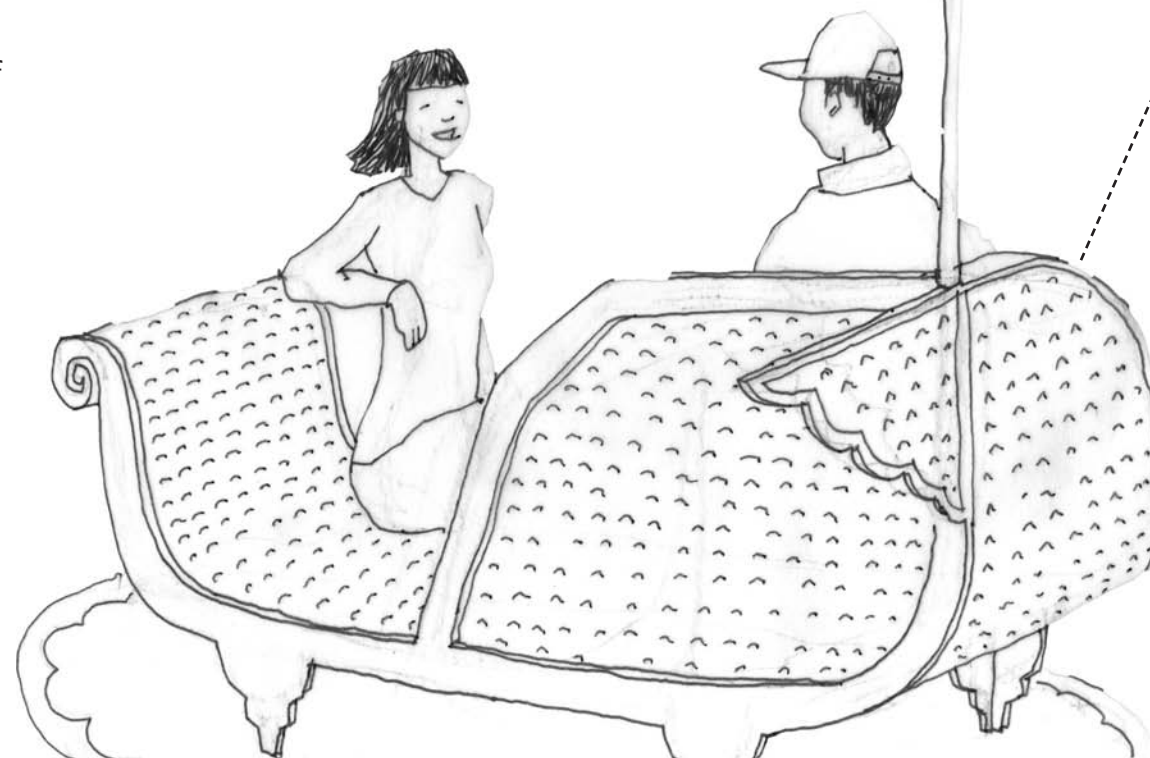

Detail of sample of perforated metal in scallop pattern to connect to the scalloped wings on the Storm Glass Hut and the sunail panel on the Sundial Windflute. Perforations allow for water to pass through and also for the surface area to cool easy providing a comfortable surface temperature for sitters.

2800

800

450

The oval concrete slab provides the footing for the chaise lounge as well as offering the opportunity to create a more domestic setting with a rug like pattern in the edge of the 'rug'.

Heidi Axelsen & Hugo Moline © 2012

The Observatory

Cabarita Site Plan



Detail of location of artworks

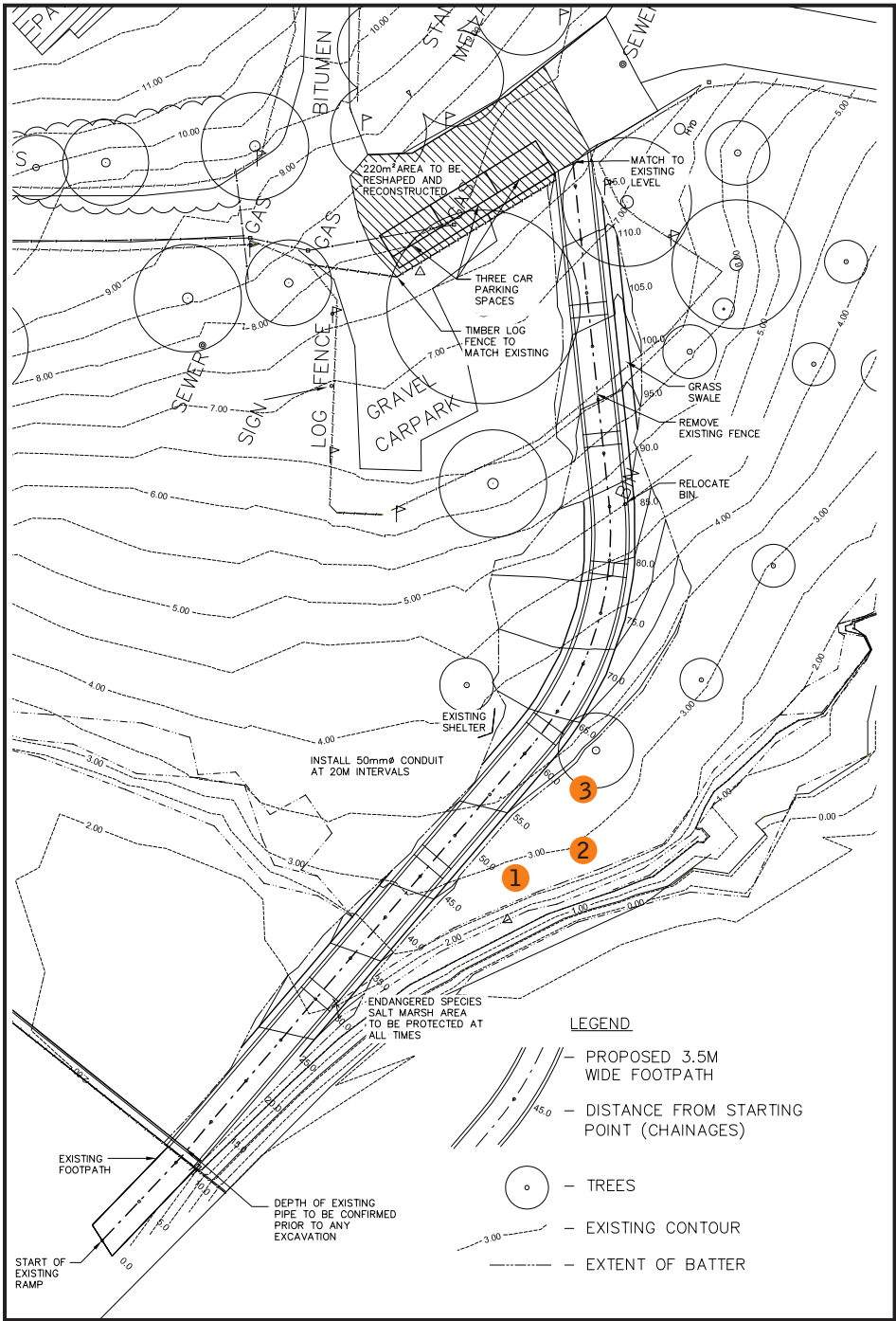

- 1 Storm Glass Hut
- 2 Sundial Wind Flute
- 3 Chaise Lounge Observatory